

**New Property Coming on Board**  
**Updated 9/27/2023**

**Spencer Court Redevelopment, Redmond**

Redevelopment of underutilized site that had 16 obsolete units built in the 1980s. 60 units of modern workforce housing (12 one-bed, 33 two-bed, 15 three-bed) in 4 garden style buildings. Construction started 7/2023 and be completed by 6/2024. Some residents will stay in place during construction, and some have relocated offsite. Current residents have preference for new units.



**College View, Simpson Ave., Bend (Westside)**

59 units workforce housing (11 one-bed, 36 two-bed and 12 three-bed) townhome and garden style buildings plus 40 standalone homes available for purchase developed and sold by Rooted Homes (fka Kor Housing). Construction will start June 2024 and be completed by Summer 2025.



**Cleveland Commons, Bend**

33 units permanent supportive housing for chronically homeless households (24 studio and 9 one-bed). Service provider will be Shepherd's House. Construction to start in fall 2023 and be completed by fall 2024.



### **Antler Site, Redmond**

Potential site for Housing Works' new admin building and 60 units of affordable housing. Partnering with Rooted Homes for 16 ownership units.

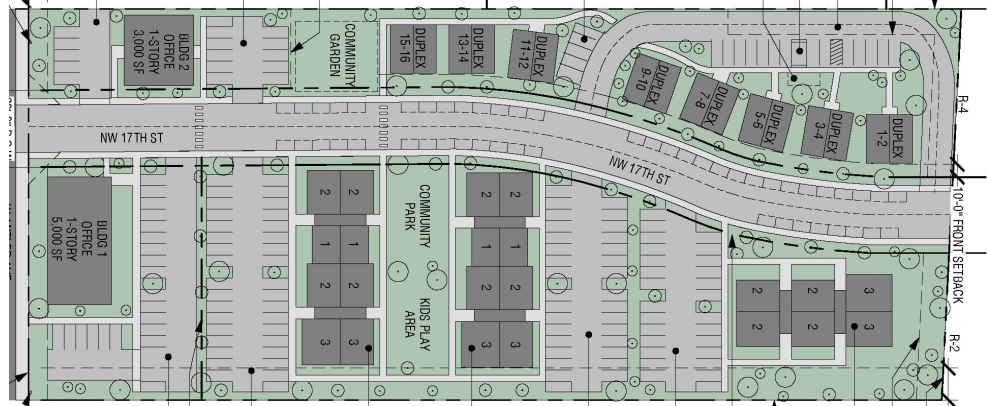

### **Hunnington Rd., La Pine**

Potential site for 50 units of rental housing and 12 cluster homes for purchase through Rooted Homes (fka Kor Housing).



COTTAGE ELEVATION



### **Connors Crossing III, Nine Peaks, Bend next to Legacy**

Three story building with 45 units of workforce housing. Housing Works owns the land and will be pursuing financing.

